

## INDUSTRIAL DUAL HANDLE WALL MOUNT POT FILLER

**CF-K30-200-XX**



## Features

- All brass construction
- 22-3/16" wall to center
- 1/4 turn ceramic disc cartridge(s)
- Dual jointed swing spout
- 1/2" FIP inlet quick connect for ease of installation
- Max flow rate: 4.0 gpm (15.1L/min) at 60 psi
- Over 30 finishes including 15 PVD finishes



### Codes/Standards Applicable

Meets or exceeds the following at date of manufacture:

- ASME A112.18.1/CSA B125.1
- NSF/ANSI 61 & NSF/ANSI 372
- Commonwealth of MA
- ADA compliant (lever handles only)

CF-K30-200-SX SHOWN

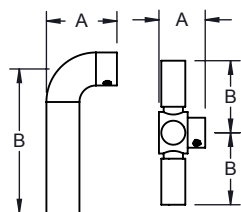
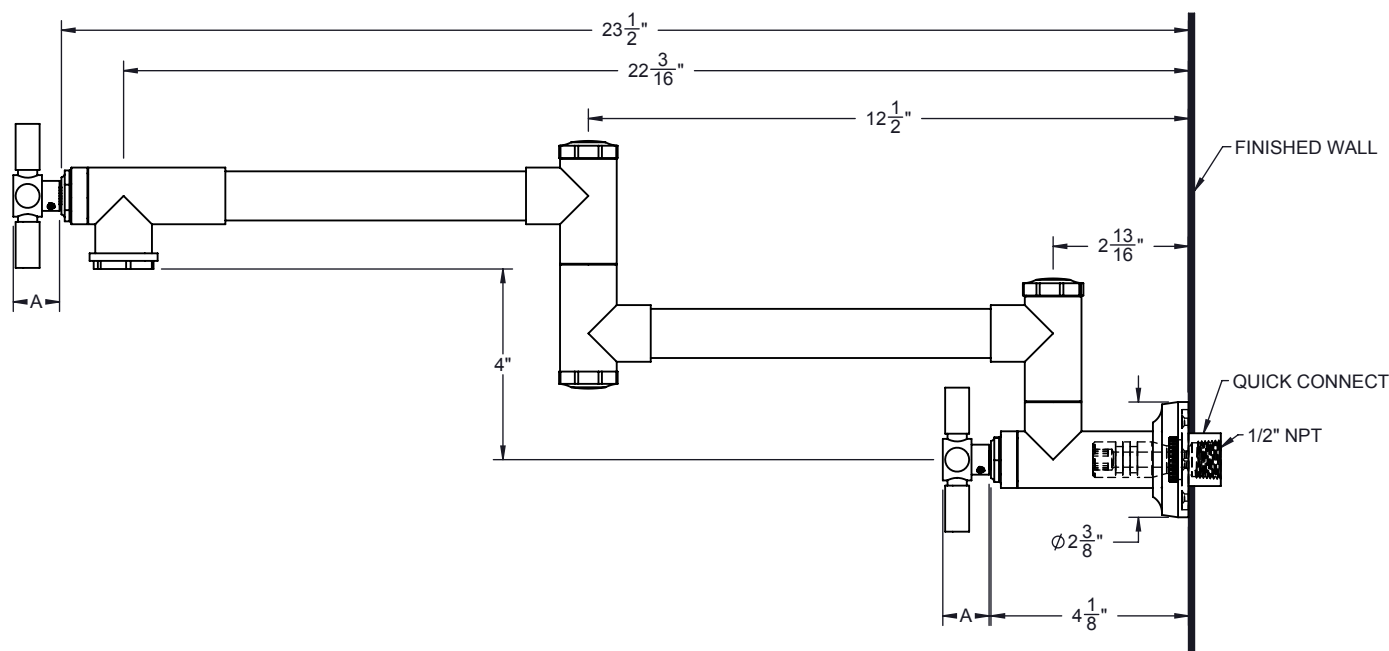

SERIES	A	B
SL	1 1/2"	3"
KL	1 1/2"	3 1/8"
FL	1 1/2"	3 1/8"
SX	15/16"	1 1/2"
KX	15/16"	1 1/2"
FX	15/16"	1 1/2"

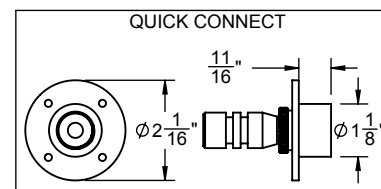
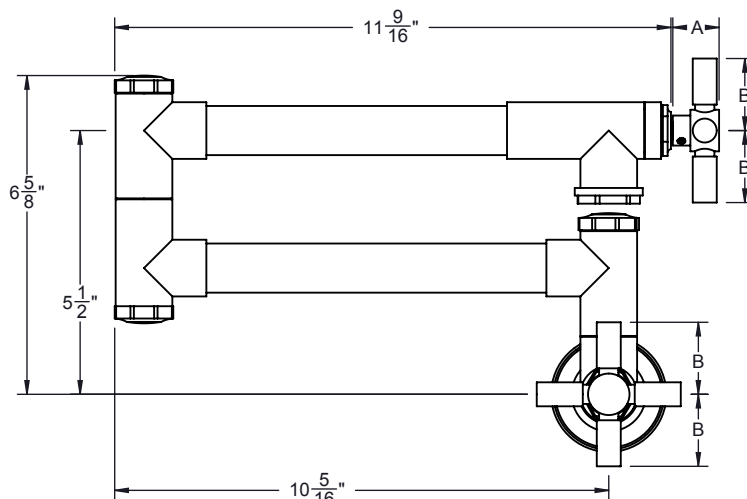

4X #6X1-1/2" SCREW  
(USED ON QUICK CONNECT)

## THRU-HOLE SPECIFICATIONS

<u>MIN</u>	<u>RECOMMENDED</u>	<u>MAX</u>
1-1/8"	1-1/8"	1-1/4"

SPECIFICATIONS SUBJECT TO CHANGE WITHOUT NOTICE

ALL DIMENSIONS SHOWN TO NEAREST 1/16"